

BLISS_T

THERMOSTAT 1T.91



finder[®]

SWITCH TO THE FUTURE

IB1T91 - 07/19 - Finder S.p.A. con unico socio - 10040 ALMESE (TO) - ITALY

| | Page |
|--|------|
| DIMENSIONS | 2 |
| INSTALLATION | 2 |
| POWER ON THE DISPLAY | 6 |
| THERMOSTAT OFF | 6 |
| DESCRIPTION OF KEYS AND SYMBOLS | 7 |
| DAY OR NIGHT TEMPERATURE SETTING | 8 |
| OFF STATE & FROST PROTECTION FUNCTION | 9 |
| SUMMER/WINTER SETTING | 9 |
| LOCK/UNLOCK THERMOSTAT | 10 |
| TECHNICAL FEATURES | 11 |

DIMENSIONS

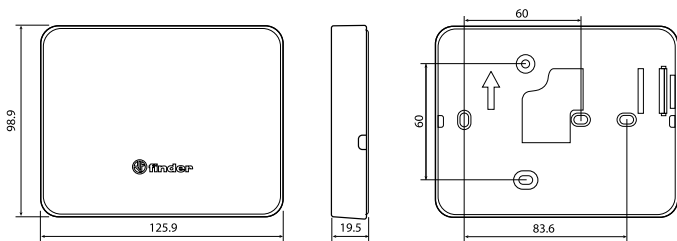

INSTALLATION

SAFETY REQUIREMENTS

The installation and assembly of electrical equipment must be performed by expert personnel.

Before connecting the thermostat make sure that the load (pumps, valves, boiler, etc ...) are not powered-up and are within the rating of the contact.

POSITIONING

Install the thermostat away from heat sources (radiators, direct sunlight, kitchens) and doors/windows. Mount about 1.5 meters above floor level.

FIXING

Use screws \varnothing 3.5 mm. Maximum head thickness 3 mm.

When fastening, take care not to over tighten the screws to avoid distorting the base.

NOTE

Use only a damp cloth for cleaning.

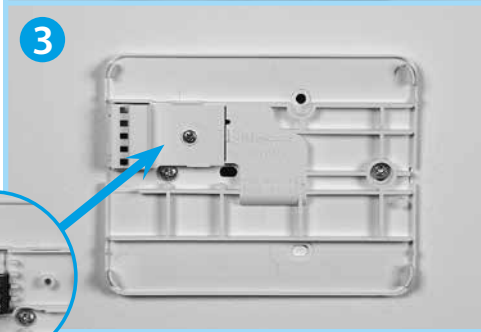
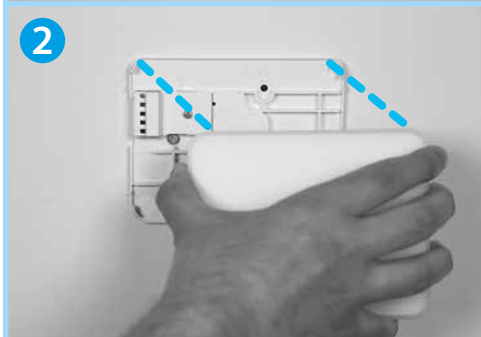

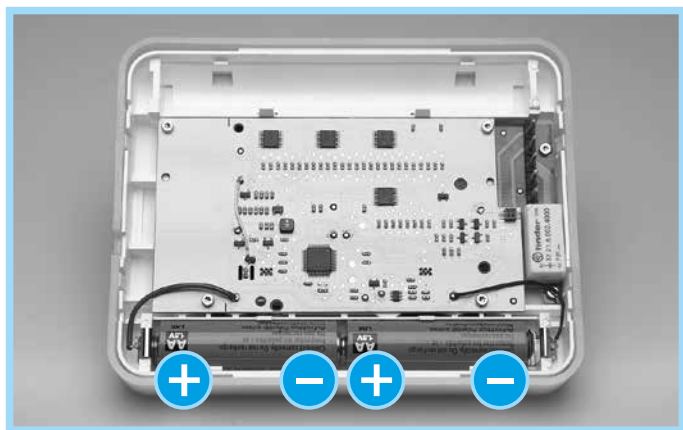
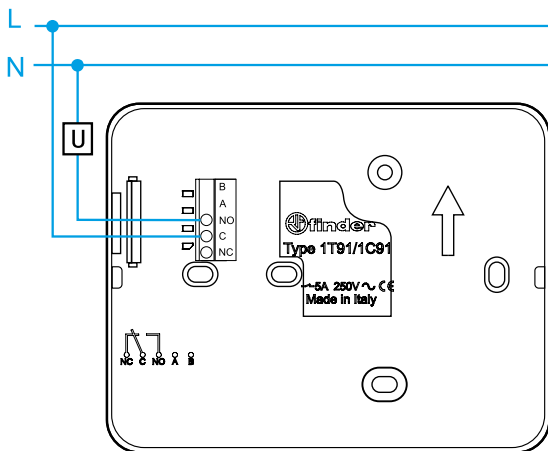

Insert the batteries into the battery compartment, respecting the indicated polarities.

CAUTION Incorrect positioning of the batteries (polarity inversion) can damage the thermostat.

The thermostat is provided with 2 battery thresholds: the first threshold indicates that the batteries are low and must be replaced. In this condition, the display in the off state and a flashing battery icon will show every 5 sec.



After touching the Finder button and turning on the display, the battery icon will continue to flash.

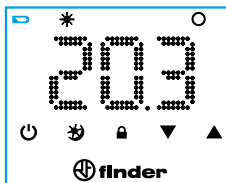

At the second threshold the thermostat turns off, the output relay will be set to OFF and it will no longer be possible to make any further adjustments. In this condition the flashing battery icon can be seen every 5 seconds (until the batteries completely run out).



Touching the word "Finder" to turn on the thermostat results in BAT and OFF alternating on the display.

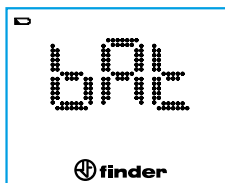

POWER ON THE DISPLAY



THERMOSTAT OFF

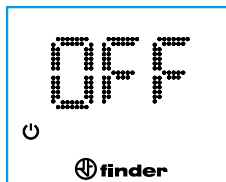
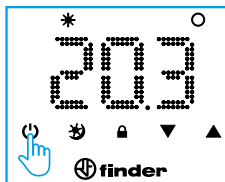

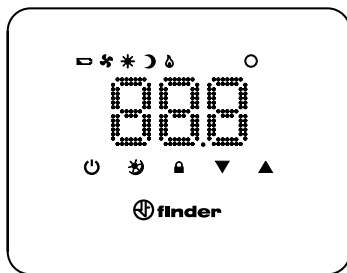

Switch on display/confirm
Press for 2" to save and exit



Thermostat switching on/off
Press for 3" to access the settings



Change mode DAY/NIGHT



Thermostat lock/unlock



Increase



Decreases



Low battery



Output ON (SUMMER setting)



Day setting



Night setting



Output ON (WINTER setting)



Degree centigrade

Example: Daytime temperature setting

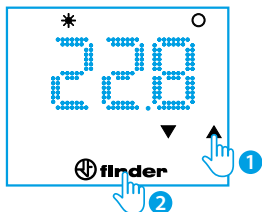
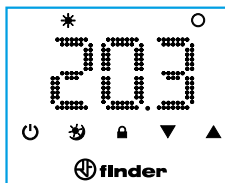

Example: Night temperature setting

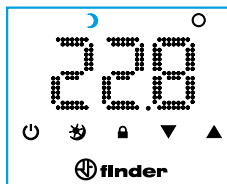
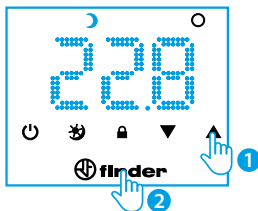
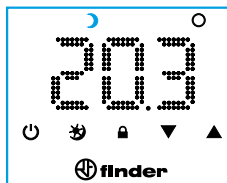
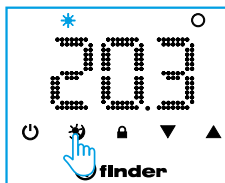
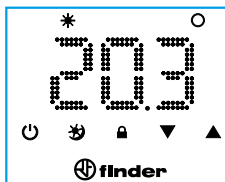

OFF STATE & FROST PROTECTION FUNCTION

When the chronothermostat is off, the display will show the word OFF. But in this condition the frost protection function remains active. If the room temperature falls below the frost protection temperature, the flame icon will appear together with the word OFF

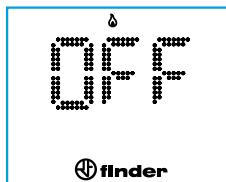
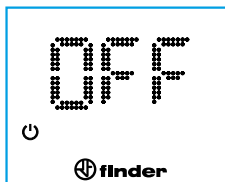

SUMMER / WINTER SETTING

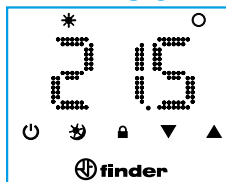
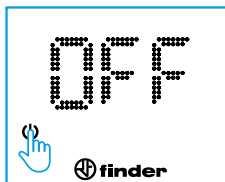
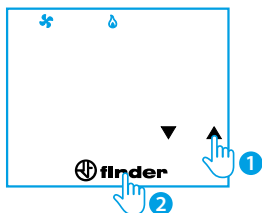
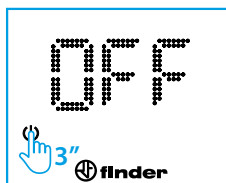
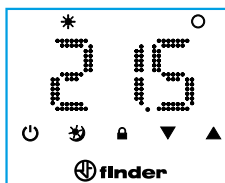

Thermostat lock

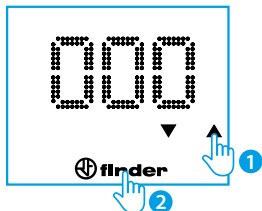
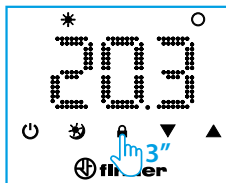

Thermostat unlock

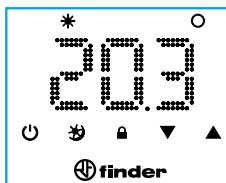
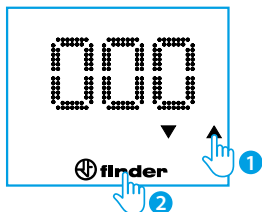
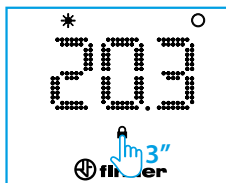

Caution

By entering an incorrect PIN code, the thermostat will display Err for an instant and then re-presents the locked display. After entering the wrong PIN 3 times, the thermostat will remain locked for 20 seconds with Err displayed (the display will turn off after 5 seconds to preserve the batteries). This procedure repeats for any further attempt to enter the wrong PIN.

NOTE

Removing the batteries will not cancel the lock.
If you forget your PIN, use code 513 to unlock the product

Power supply: **2 alkaline batteries 1.5 V type AA (life approx. 2 years)**
 Temperature adjustment WINTER/SUMMER - NIGHT/DAY: **(+5...+37)°C**
 Resolution: **0.1°C**
 Accuracy: **+/- 0.5°C at 20°C**
 Differential: **0.2°C - Self-regulating**
 Operating modes: **Summer - Winter - Day - Night**
 Degree of protection: **IP20**
 PIN lock: **Yes, 3 digits**
 Output: **5 A 250 V AC volt-free changeover contact**
 Mounting: **Wall**

DEFAULT PARAMETERS

| | |
|------------------|--------------|
| Season set | Winter |
| Frost protection | Fixed at 5°C |